

NOTE: ALL UPRIGHTS TO HAVE SOLID 30x60 FLAT INFILL BETWEEN 60x60 UPRIGHTS WHERE BALUSTRADE TERMINATES OR CHANGES DIRECTION IN PLAN

FIXING TO EXISTING 150x50 TIMBER FRAMING CONTINUOUS 100x100x10 ANGLE WITH M12 FIXINGS TO EX STUDS AT EACH CROSSING ANGLE TO BE FIXED DIRECTLY TO STUDS WITH WALL LINING CUT AROUND ANGLE

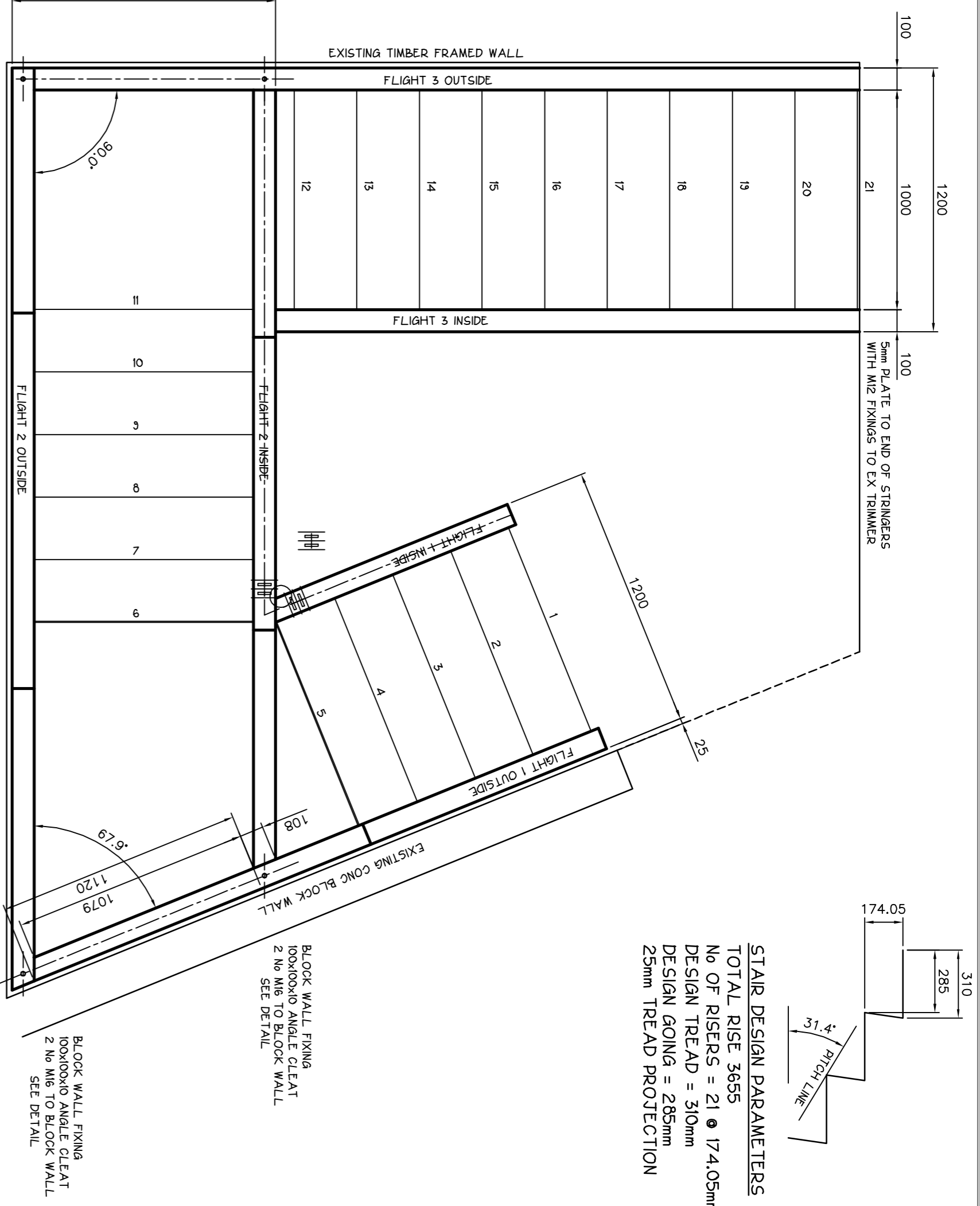

STAIR DESIGN PARAMETERS
 TOTAL RISE 3655
 No OF RISERS = 21 @ 174.05mm
 DESIGN TREAD = 310mm
 DESIGN GONGA = 285mm
 25mm TREAD PROTECTION

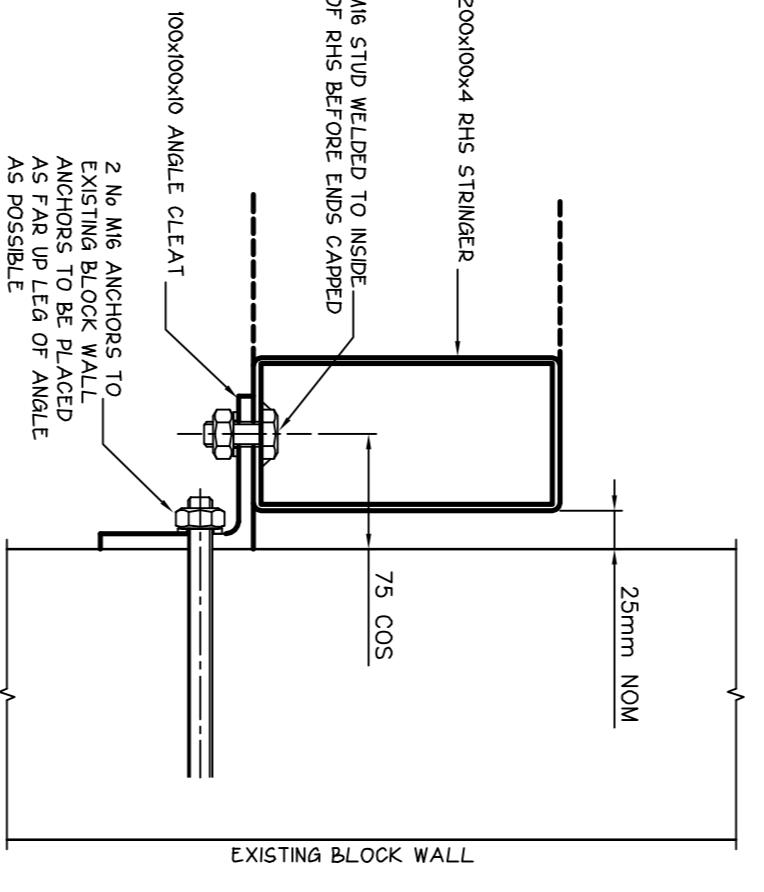
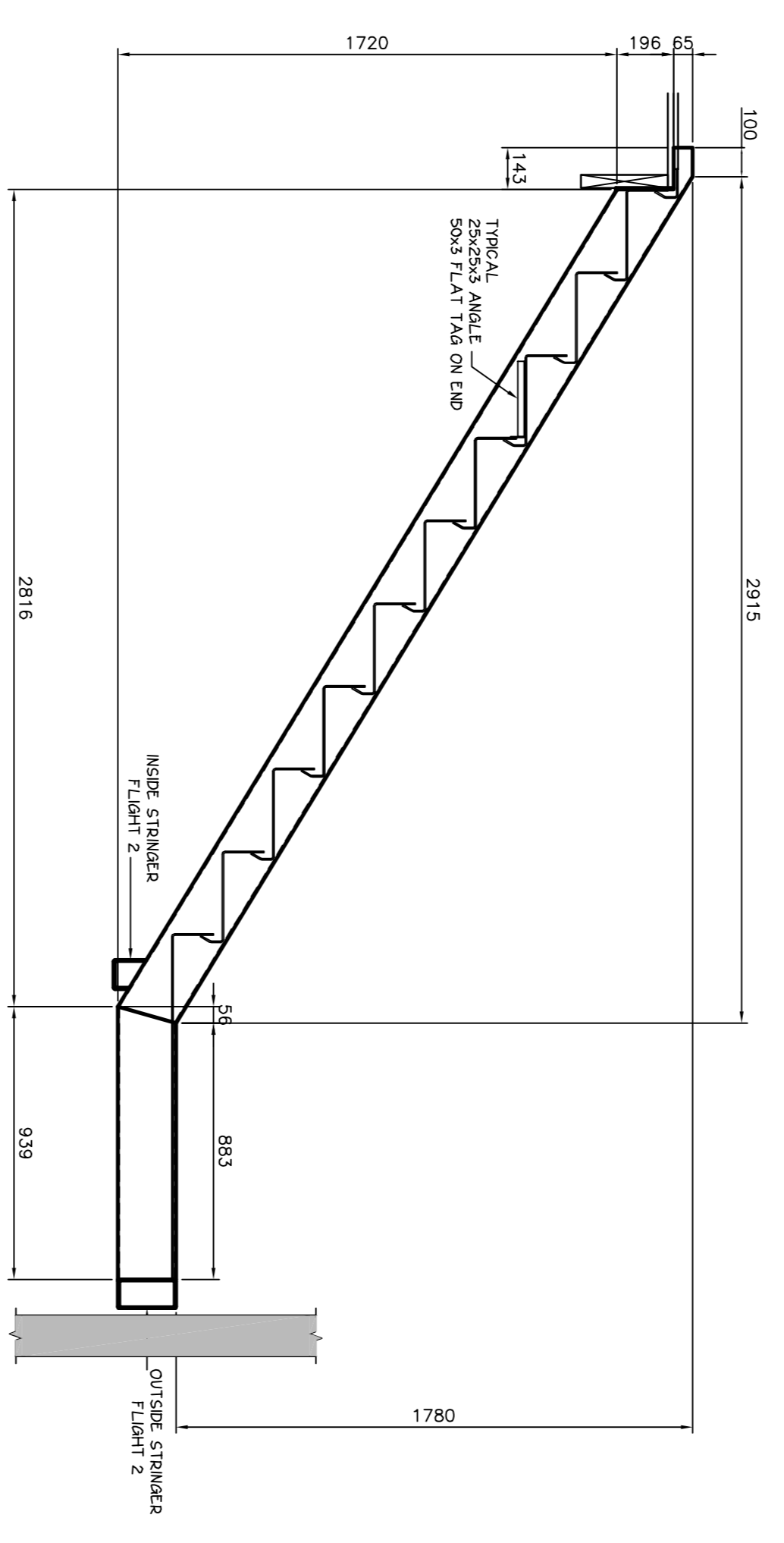

OUTSIDE STRINGER FLIGHT 3

BLOCK WALL CLEAT SCALE 1:5

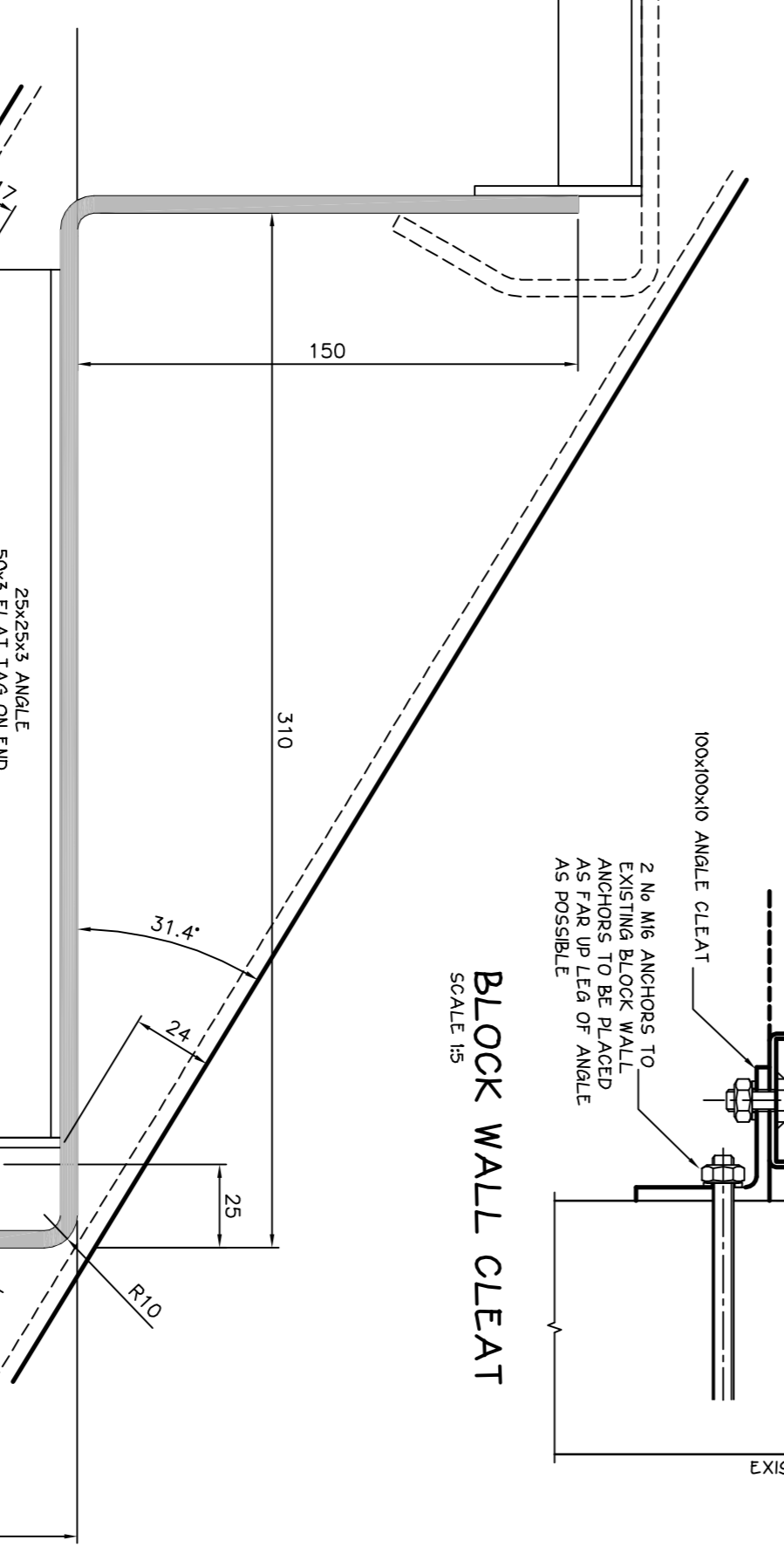
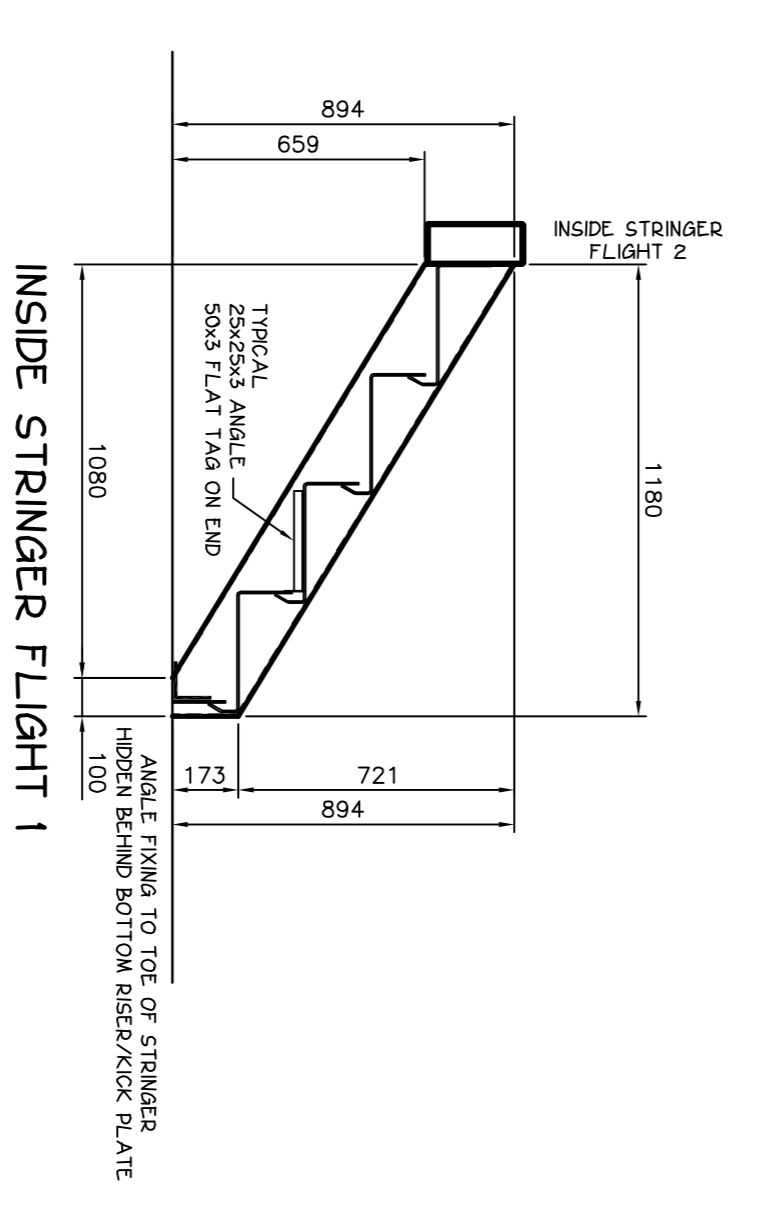

INSIDE STRINGER FLIGHT 1

INSIDE STRINGER FLIGHT 2

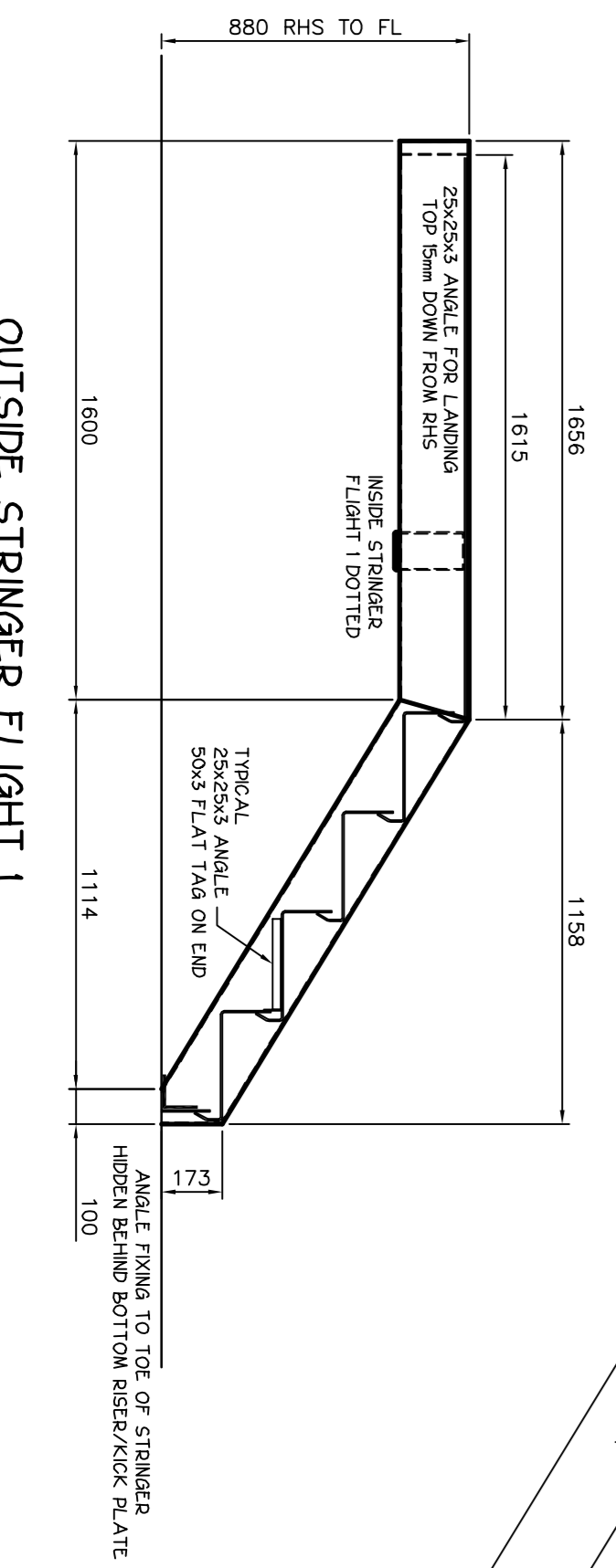
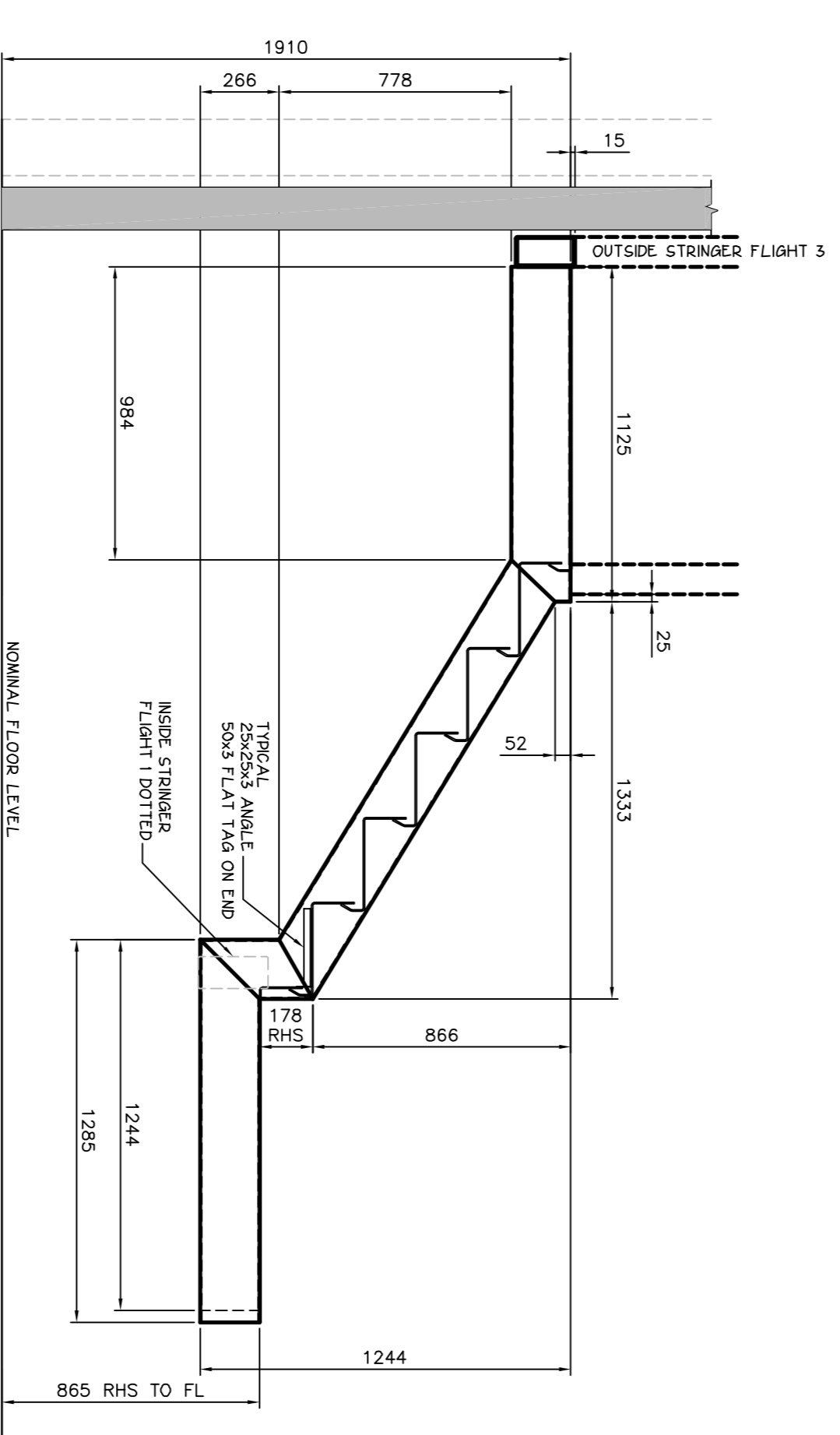

OUTSIDE STRINGER FLIGHT 1

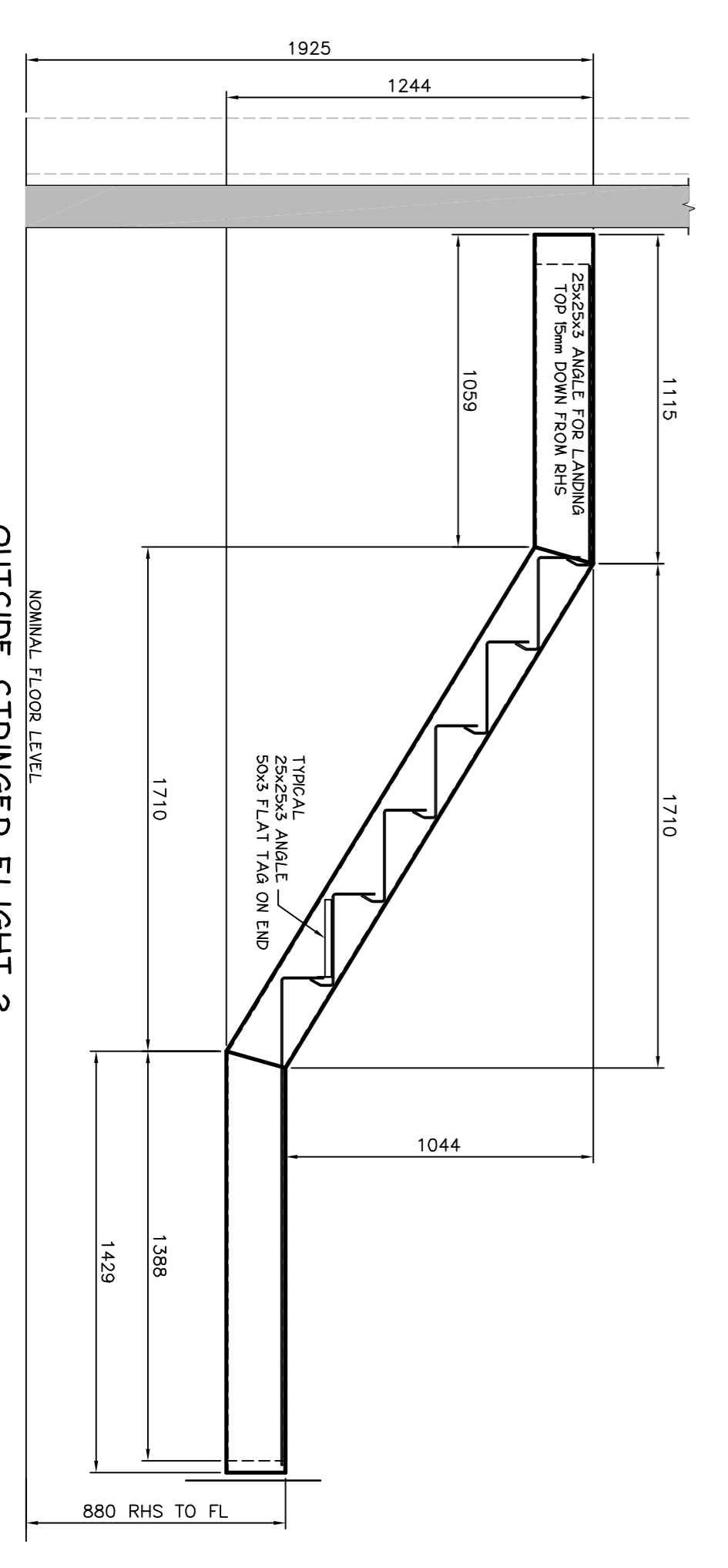

OUTSIDE STRINGER FLIGHT 2

NOTES:

CHECK ALL DIMENSIONS ON SITE PRIOR TO COMMENCING CONSTRUCTION ALL WORK TO BE IN ACCORDANCE WITH TERRITORIAL AUTHORITIES BYLAWS AND GUIDELINES

NO	REVISION DETAILS	DATE

cadworx@paradise.net.nz
 PO box 40-223 Upper Hutt
 ph 04-971-8469
 fax 04-971-8409
 mob 027-244-5967



DRAWING NO	REVISION